

SECTION 4D

PARKING BRAKE

TABLE OF CONTENTS

Description and Operation	4D-2	Component Locator	4D-5
Parking Brake	4D-2	Cross Sectional View	4D-5
Parking Brake Switch and Indicator	4D-2	Parking Brake Lever and Cable	4D-6
Braking Inspection	4D-2	Repair Instructions	4D-7
Specifications	4D-3	On-Vehicle Service	4D-7
Diagnostic Information and Procedure	4D-4	Parking Brake	4D-7

دیجیتال خودرو

شرکت دیجیتال خودرو سامانه (مسئولیت محدود)

اولین سامانه دیجیتال تعمیرکاران خودرو در ایران



DESCRIPTION AND OPERATION

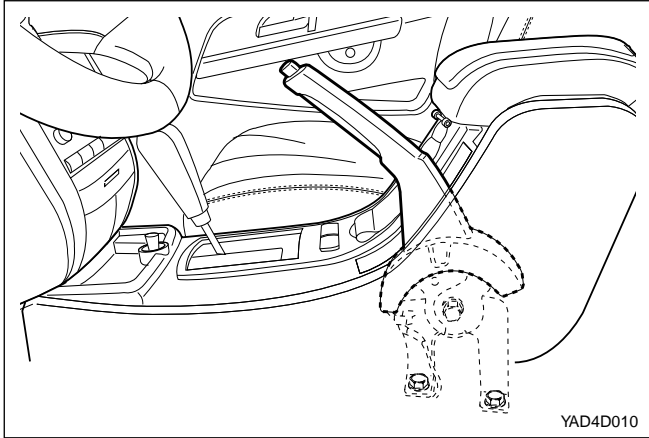

PARKING BRAKE

When the brake is firmly applied, the parking brake should the vehicle with ample pedal travel remaining. Check for frayed cables, rust, etc. or any condition that may inhibit present (or future) free movement of the parking brake lever assembly.

PARKING BRAKE SWITCH AND INDICATOR

When the parking brake lever is pulled out with the ignition ON, the parking brake indicator turns on via lever switch.

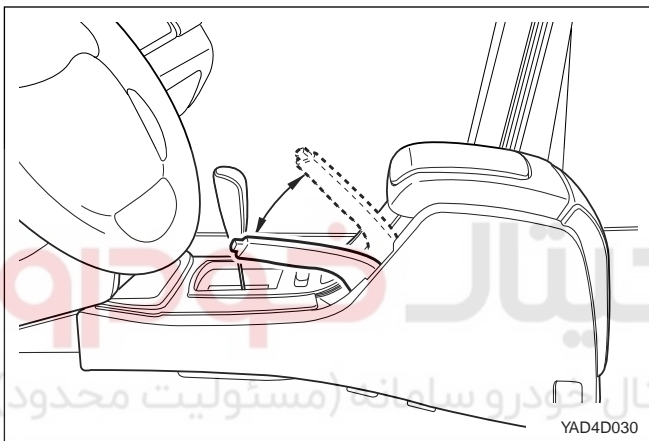

BRAKING INSPECTION

Inspect the parking brake as following;

1. Count the number of the notch sounds on pulling out the parking brake at 19kg force.

Specified Notch	5
-----------------	---

2. If the notch number is over the specified value, adjust the notch number by the parking brake cable adjusting nut.
3. Check the parking brake force after adjusting the specified value.
4. If the braking force is not operated properly, check the parking brake lever and cable and replace them as needed.

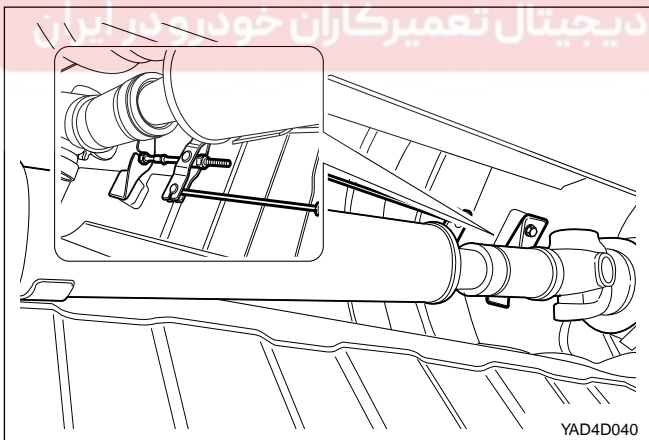

SPECIFICATIONS

Application		Spec.
Parking Brake	Type	Mechanical Rear-Wheel Drive Internal Expanded
	Operation	Manual

دیجیتال خودرو

شرکت دیجیتال خودرو سامانه (مسئولیت محدود)

اولین سامانه دیجیتال تعمیرکاران خودرو در ایران



DIAGNOSTIC INFORMATION AND PROCEDURE

Symptom	Possible Cause	Action
Poor Braking	Lining Wear, Hardening	Replace
	Oil Or Water Contamination On The Lining	Replace Or Repair
	Brake Cable Sticked Or Damage	Replace
	Excessive Pedal Travel	Notch Adjustment
	Inoperative Clearance Automatic Control System	Repair

دیجیتال خودرو

شرکت دیجیتال خودرو سامانه (مسئولیت محدود)

اولین سامانه دیجیتال تعمیرکاران خودرو در ایران



COMPONENT LOCATOR

CROSS SECTIONAL VIEW

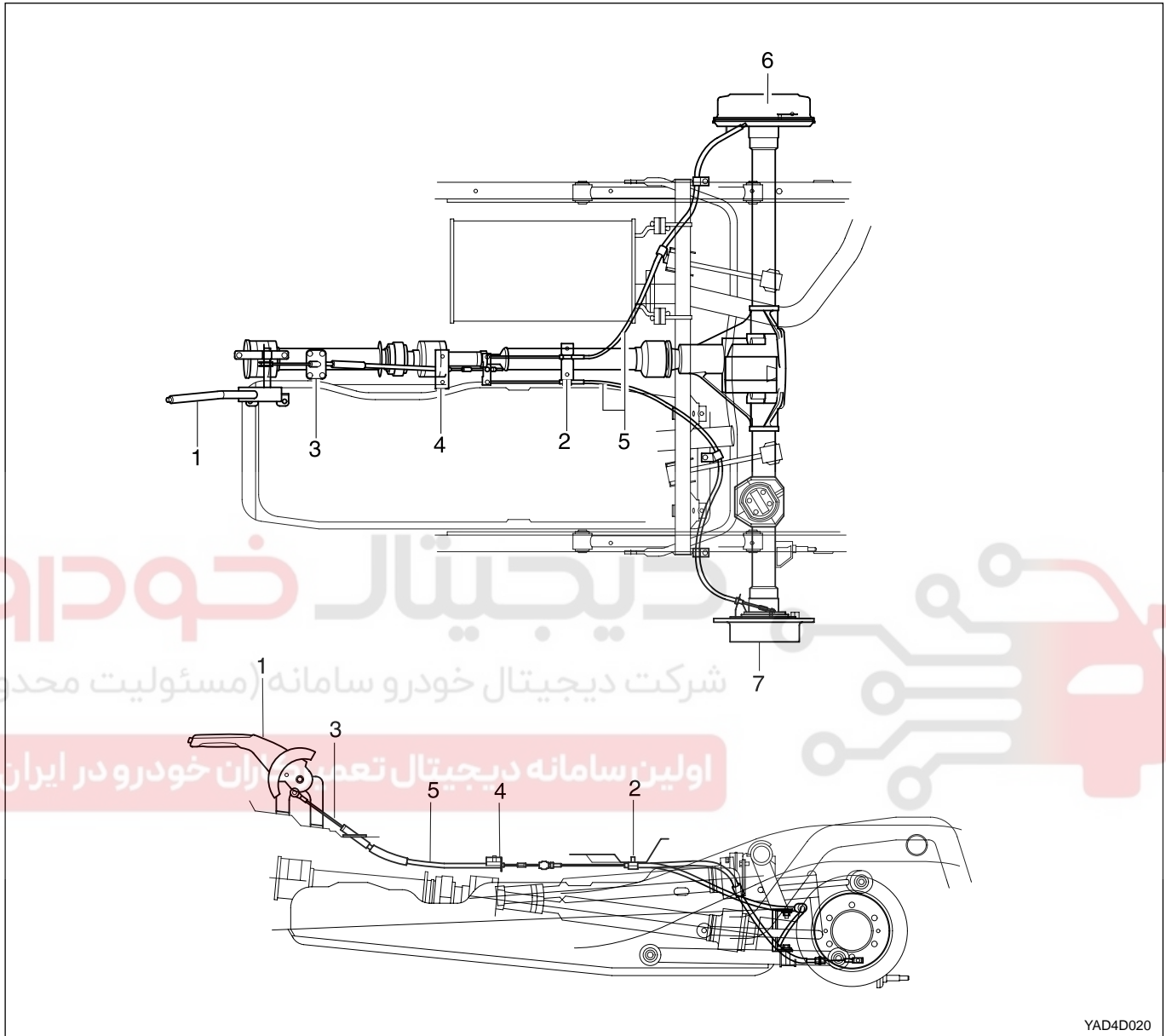

- 1 Parking Brake Lever
- 2 Parking Brake Cable Bracket (Rear)
- 3 Parking Brake Cable Bracket (Front)
- 4 Parking Brake Cable Bracket (Center)

- 5 Cable
- 6 With Drum Brake
- 7 With Disc Brake

PARKING BRAKE LEVER AND CABLE

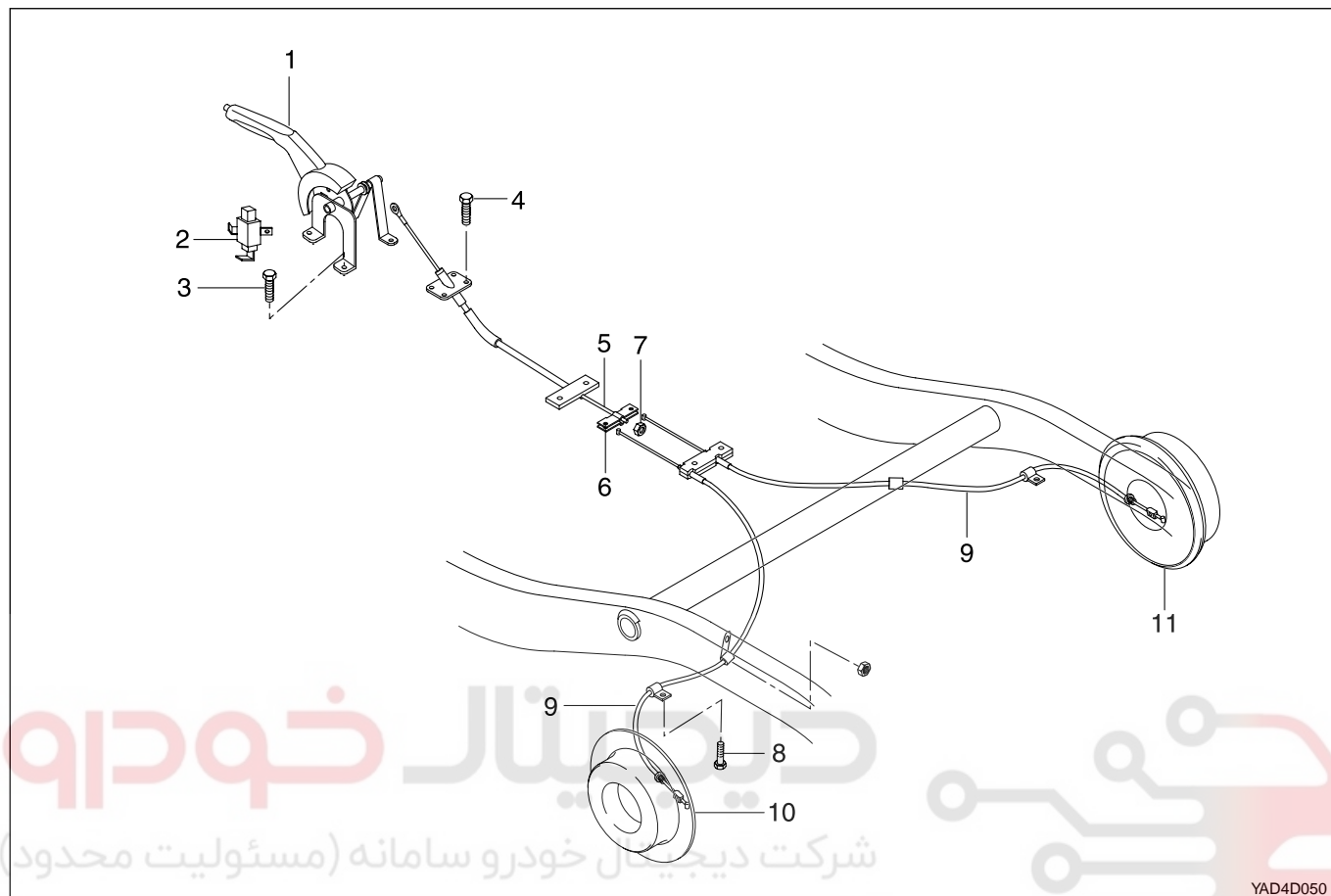

YAD4D050

- | | |
|-------------------------------------|--------------------------------------|
| 1 Parking Brake Lever | 7 Nut |
| 2 Parking Brake Warning Lamp Switch | 8 Bolt |
| 3 Bolt | 9 Rear Parking Brake Cable |
| 4 Bolt | 10 Brake Disc (Rear Disc Brake Type) |
| 5 Front Parking Brake Cable | 11 Brake Drum (Rear Drum Brake Type) |
| 6 Equalizer | |

REPAIR INSTRUCTIONS

ON-VEHICLE SERVICE

PARKING BRAKE

Removal Procedure

1. Remove the console assembly.
2. Disconnect the parking brake warning lamp connector.
3. Disconnect the cable from the parking brake lever with parking brake released.

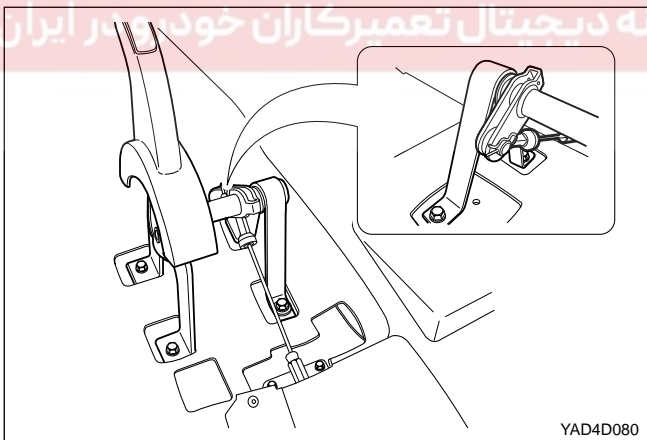
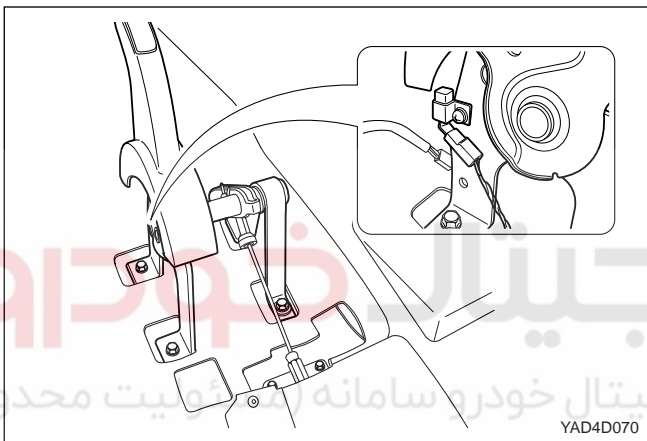
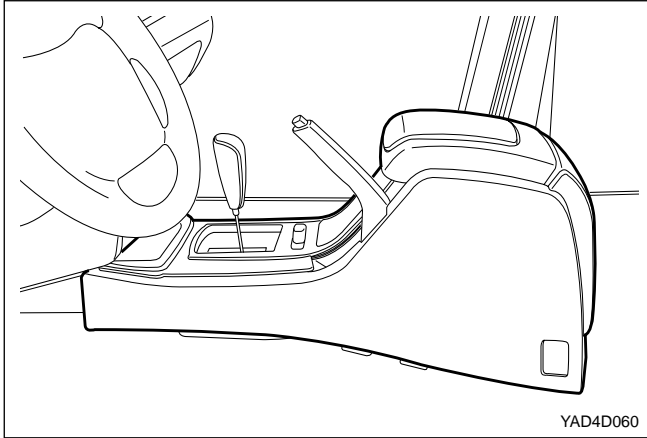

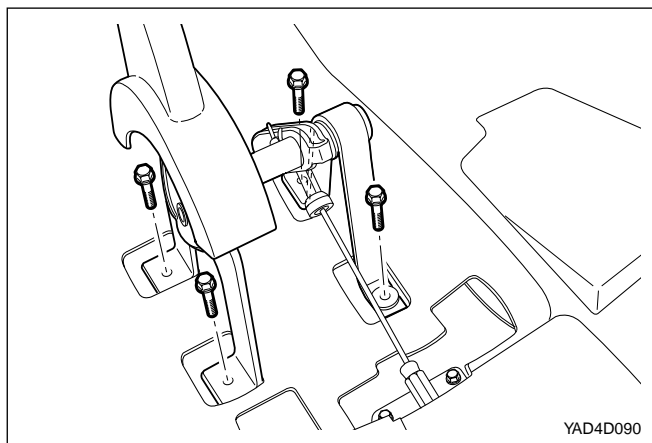

4. Remove the parking brake lever bracket mounting bolt and remove the lever assembly.

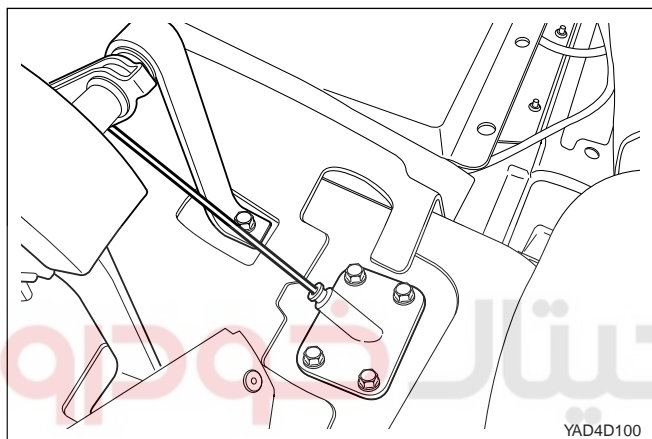

5. Remove the cable plate at the under floor.

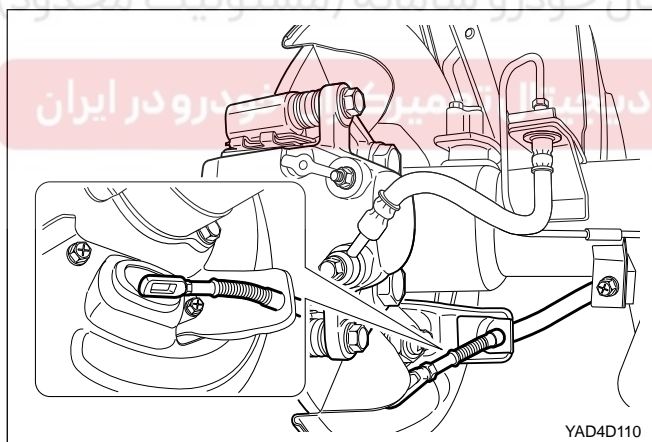

6. Disconnect the parking brake cable from the rear brake.

Disc Type

- Disconnect the cable from the parking brake lever.
- Remove the clip from the brake plate.

Drum Type

- Remove the clip from the brake plate.
- Move the parking brake lever as shown using driver etc. and then disconnect the cable.

7. Disconnect the cable bracket and the cable.

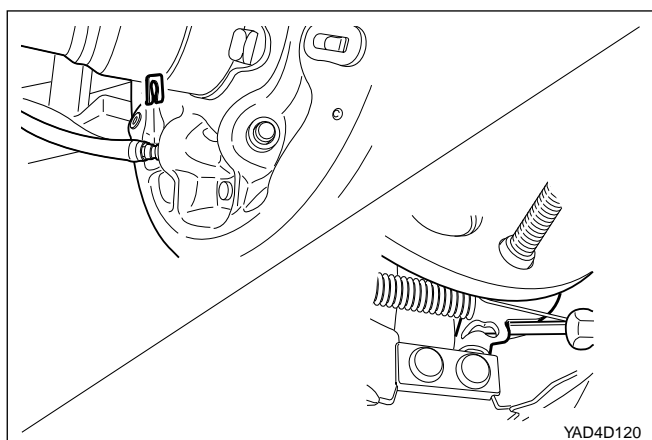

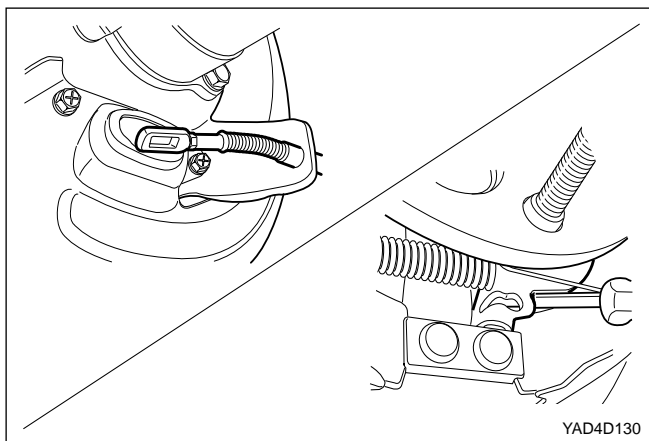

Installation Procedure

1. Connect the parking brake cable to the parking brake lever.
2. Install the bracket with the parking brake cable to the body.

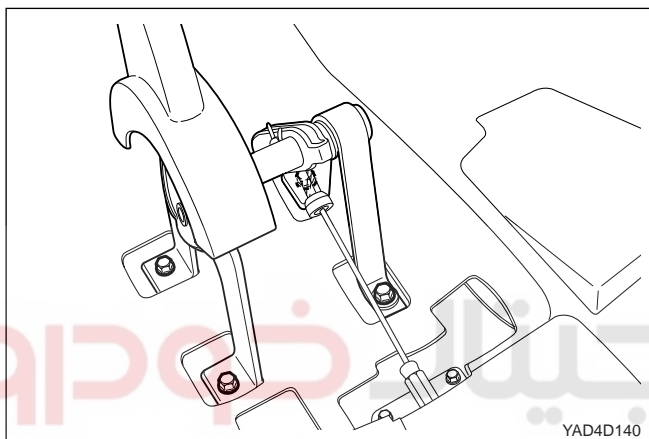

3. Install the parking brake lever assembly.

Installation Notice

Tightening Torque	22 N•m (16 lb-ft)
-------------------	----------------------

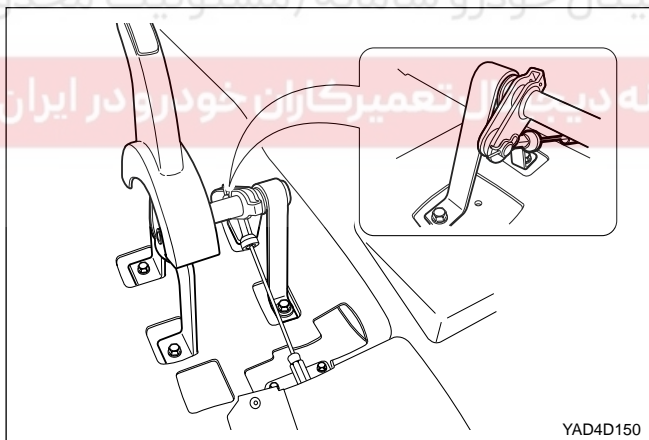

4. Insert the parking brake cable to the lever hole and install the cable plate.

Installation Notice

Tightening Torque	6 N•m (53 lb-in)
-------------------	---------------------

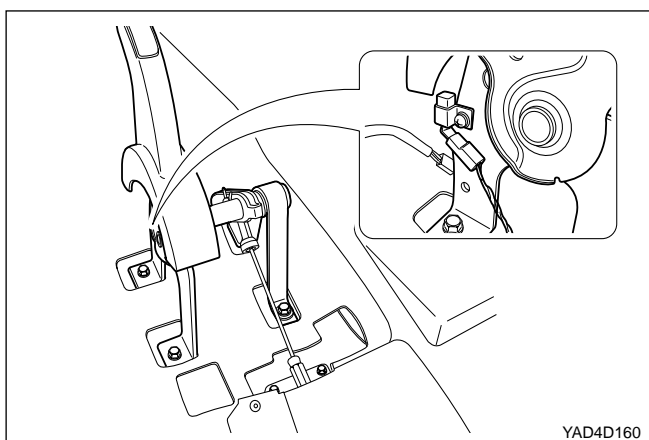

5. Install the parking brake switch and check the warning lamp and brake operation.

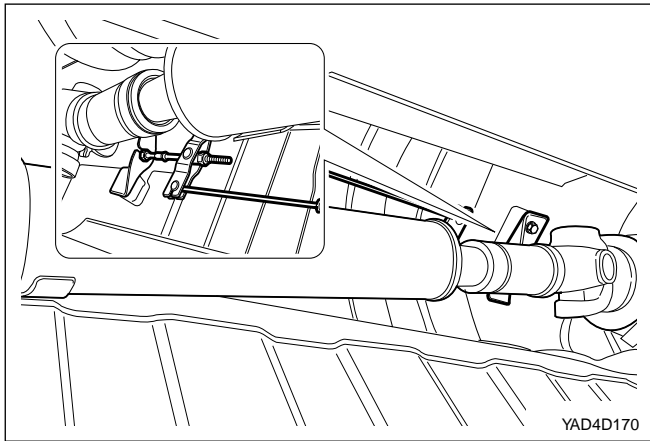

6. If there is any operation problem in the parking brake, adjust the cable tension at the equalizer position.
7. Install the console assembly and perform the braking test.

دیجیتال خودرو

شرکت دیجیتال خودرو سامانه (مسئولیت محدود)

اولین سامانه دیجیتال تعمیرکاران خودرو در ایران

